



Well presented two bedroom first floor flat ideally located in central Jesmond! This generous and bright first floor apartment is located within this prestigious 1930's mansion block, ideally positioned on Osborne Avenue within South Jesmond Conservation Area, close to excellent amenities, transport links and Jesmond Dene.

The accommodation briefly comprises: communal entrance with secure telephone entry system and both lift and stairs access to all floors; private entrance hall with storage cupboard; 17ft lounge diner with walk in bay window, stylish kitchen with a range of fitted units, work surfaces, some integrated appliances and fire escape access, bathroom complete with three piece suite, separate storage cupboard and dual west facing windows; bedroom one with west facing window and bedroom two with dual windows. With residents parking, communal bike storage and well presented throughout, early viewings are advised to avoid disappointment!

1930's Mansion Block Apartment | 838 Sq. Ft (77.8m²) | South Jesmond Conservation Area | Two Double Bedrooms | 17ft Lounge/Diner | Modern Kitchen | Bathroom | Lift Access | Courtyard | Residents' Parking | Leasehold with 997 years remaining | Service Charge £2,904 Per Annum | Council Tax Band C | EPC Rating: C.



FIRST FLOOR
838 sq.ft. (77.8 sq.m.) approx.

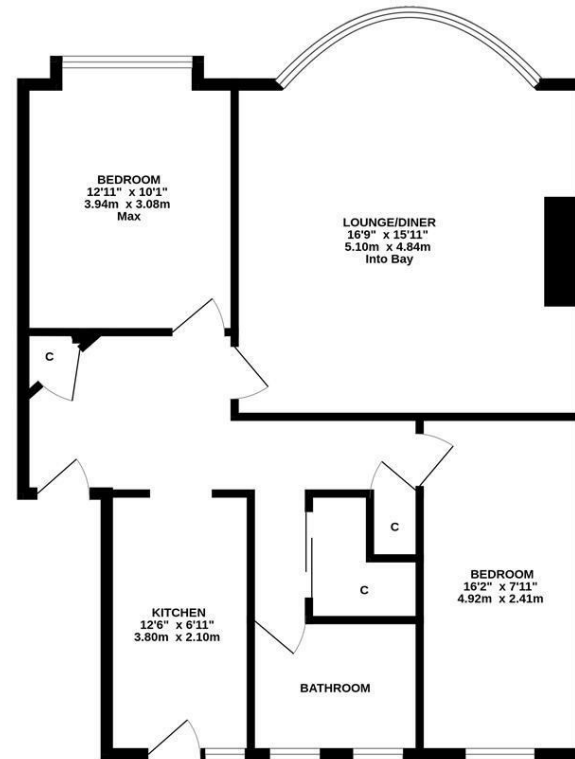

TOTAL FLOOR AREA: 838 sq.ft. (77.8 sq.m.) approx.
Whilst every attempt has been made to ensure the accuracy of the floorplan contained here, measurements of doors, windows, rooms and any other items are approximate and no responsibility is taken for any error, omission or mis-statement. This plan is for illustrative purposes only and should be used as such by any prospective purchaser. The services, systems and appliances shown have not been tested and no guarantee as to their operability or efficiency can be given.
Made with Metropix ©2026



Offers Over £200,000

IMPORTANT NOTE: These particulars and the descriptions and measurements herein do not constitute representation and whilst every effort has been made to ensure accuracy, this cannot be guaranteed.

